

# T-fal®

EN

## POWERGLIDE Anti-Calc



[www.t-falusa.com](http://www.t-falusa.com)





# SUMMARY

## IMPORTANT SAFETY RECOMMENDATIONS

Important safety recommendations .....	p. 5
Before first use .....	p. 7

## PREPARATION

Which water should I use? .....	p. 8
Filling the water tank .....	p. 8

## USE

Adjusting the temperature and steam .....	p. 9
Dry ironing .....	p. 10
Getting more steam .....	p. 10
Vertical steam ironing .....	p. 11
Dampening clothing (Spray) .....	p. 12
While ironing .....	p. 12
Auto-Off Function (according to model) .....	p. 12

## IRON STORAGE AND MAINTENANCE

Iron storage .....	p. 13
Cleaning the anti-calc Collector .....	p. 14
Cleaning the anti-calc valve (once per month) .....	p. 15
Descaling the steam chamber (3 times a year) .....	p. 16
Cleaning the soleplate .....	p. 17

## IS THERE A PROBLEM WITH YOUR IRON?

Problems, possible causes, solutions .....	p. 18
--	-------

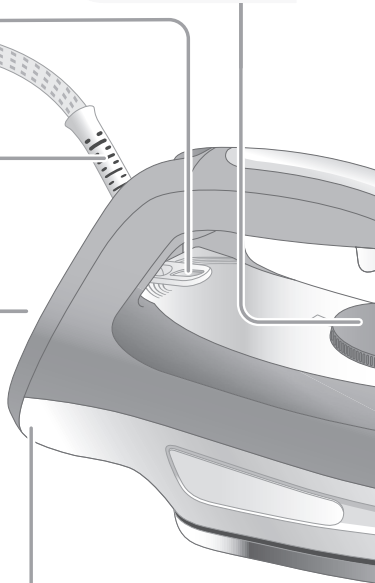
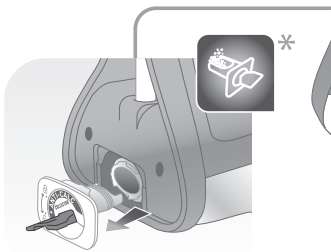
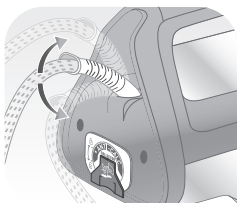
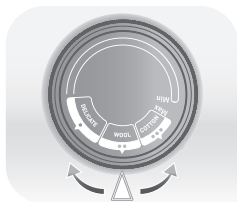
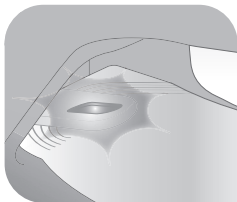

\* EN According to model

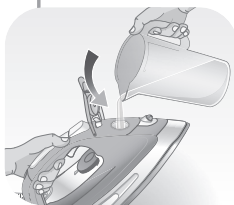
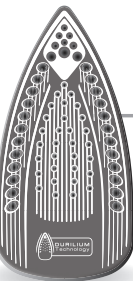
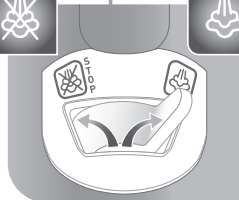
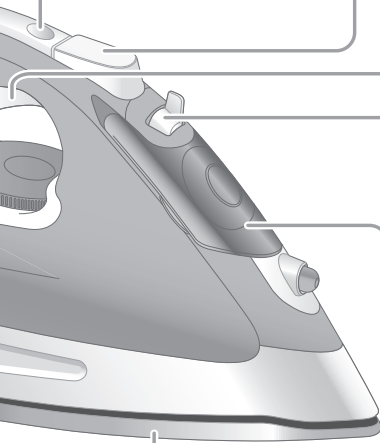

## IMPORTANT SAFETY INSTRUCTIONS

### **Read all instructions before using the iron.**

When using your iron, basic safety precautions should always be followed, including the following:

1. Use iron only for its intended use.
2. To protect against a risk of electric shock, do not immerse the iron in water or other liquids.
3. Always turn the iron OFF before plugging or unplugging the iron from the electrical outlet. Never pull on the cord to disconnect the iron from the electrical outlet; instead, grasp the plug and pull on the plug to disconnect the iron.
4. Do not allow cord to touch hot surfaces. Let iron cool completely before putting away. Loop cord loosely around iron when storing.
5. Always disconnect iron from electrical outlet when filling with water or emptying and when not in use.
6. Do not operate iron with a damaged cord or if the iron has been dropped or damaged. To avoid the risk of electric shock, do not disassemble the iron. Contact our Consumer Service Department for examination, repair or adjustment. Incorrect reassembly can cause a risk of electric shock when the iron is used.
7. Close supervision is necessary for any appliance being used by or near children. Do not leave iron unattended while connected or on an ironing board.
8. Burns can occur from touching hot metal parts, hot water or steam. Use caution when you turn a steam iron upside down - there may be hot water in the reservoir.
9. This appliance is only for domestic and personal use.

## **SPECIAL INSTRUCTIONS**

1. To avoid a circuit overload, do not operate another high-wattage appliance on the same circuit.
2. If an extension cord is absolutely necessary, a 15 amp. cord should be used. Cords rated for less amper may overheat. Care should be taken to arrange the cord so that it cannot be pulled or tripped over.

### **SAVE THESE INSTRUCTIONS**

#### **For your safety**

### **PLEASE READ THESE INSTRUCTIONS CAREFULLY AND KEEP THEM FOR FUTURE REFERENCE.**

This appliance complies with the technical rules and standards for safety currently in force (Electromagnetic Compatibility, Low Voltage, Environnement).

- This appliance is not intended for use by persons (including children) with reduced physical, sensory or mental capabilities, or lack of experience and knowledge, unless they have been given supervision or instruction concerning use of the appliance by a person responsible for their safety. Children must be supervised to ensure that they do not play with the appliance.
- During the first few uses, a harmless odour and a small amount of smoke may be given off. This has no effect on the use of the iron and will disappear quickly.
- Warning ! The voltage of your electrical installation must correspond to that of the iron (120V or 127 V). Connecting to the wrong voltage may cause irreversible damage to the iron and will terminate the guarantee.
- If it is absolutely essential to use an extension cable, choose a 15 amp cord.
- If the electrical cord becomes damaged, it must be immediately replaced by an Approved Service Centre to avoid any danger.
- The appliance should not be used if it has fallen, if it has obvious damage, if it leaks or functions incorrectly. Never dismantle your appliance : have it inspected by an Approved Service Centre, to avoid any danger.
- Never immerse your iron in water !
- Do not unplug your appliance by pulling on the cord. Always unplug your appliance: before filling or rinsing the water tank, before cleaning it, after each use.
- Never leave the appliance unattended when it is connected to the mains. Before storing the appliance, once it is unplugged, please wait until it has cooled down (around 1 hour).
- Your appliance gives off steam, which may cause burns. Take extra care especially when you are ironing close to the edge or on a corner of your ironing board. Never direct the steam towards people or animals.
- Your iron should be used and placed on a flat, stable, heat-resistant surface. When you put your iron onto its iron rest, make sure that the surface on which you put it is stable.
- This product has been designed for domestic use only. The manufacturer will accept no responsibility and the guarantee will be terminated, if this product is used for commercial purposes, inappropriate use or failure to comply with the instructions.

## BEFORE FIRST USE



Remove any labels from the soleplate before heating the iron.

Before using the steam function in your iron for the first time, we recommend that you allow the iron to operate a few moments in a horizontal position without coming into contact with your laundry. Keeping the iron in this position, push the steam button several times.

During the first few uses, the appliance may produce smoke, a harmless odour and a light emission of particles. These are simply the engineering residues from the manufacturing process burning off. These are harmless and will quickly disappear.



## PREPARATION

### Which water should I use?

- Your appliance was designed to operate using untreated tap water. However, it is necessary to periodically clean the steam chamber to remove any mineral deposits.
- Do not use pure demineralised or pure distilled water, water from clothes dryers, scented or softened water, rain water, filtered, bottled or boiled water, water from refrigerators, batteries or air conditioners, pure distilled water or rain water as these may damage the iron. These types of water contain organic waste, mineral elements that become concentrated when heated and cause spitting, brown staining, leaking or premature wear on your iron



If your water is very hard, mix 50% untreated tap water with 50% distilled water (available in hardware stores).

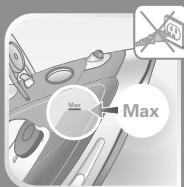

### Filling the water tank

- Unplug the iron before filling it.
- Set the steam control to 
- Lift the iron and, holding it at a slight incline, point the soleplate up.
- Open the water tank cover.
- Fill the water tank to the mark "Max".
- Close the water tank cover.

**Warning !** Do not fill your iron through the scale collector orifice. Do not remove the anti limescale collector to fill the tank.

## USE

- Plug in the appliance.

### Adjusting the temperature and steam

- Set the steam control to 
- Adjust the temperature control, referring to the table below.

FABRIC	TEMPERATURE CONTROL POSITION
LINEN	<b>Max</b>
COTTON	• • •
WOOL	• •
SILK/SYNTHETIC (Polyester, Acetate, Acrylic, Polyamide))	•

 = STEAM ZONE

- The temperature indicator light turns on.

- It will turn off automatically once the soleplate achieves the desired temperature.

Set the temperature control dial to match the type of fabric you wish to iron. Your iron automatically and accurately determines the exact temperature and steam flow that are suitable, in order to guarantee the best results.



Your iron heats quickly: begin with fabrics that require lower temperatures.

When ironing fabrics with most delicate fibres: set the ironing temperature for the most fragile fibre.

The iron will not heat up if the thermostat control is set to "Min".



### Dry ironing

- Set the temperature according to the fabric to be ironed.
- Set the steam control to 
- You may continue to iron when the indicator light turns off.



### Getting more steam

- Set the thermostat control to "Max" or "•••".



- Press the turbo steam button periodically (turbo steam).
- To avoid water dripping on the laundry, maintain an interval of a few seconds in between each press.

## Vertical steam ironing



- Hang the item on a hanger and keep the fabric taut with one hand. The steam is very hot; never steam iron clothing while it is being worn—always use a hanger.



- Set the thermostat control to “Max”

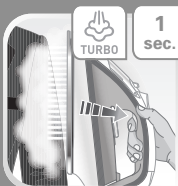

- Press the turbo steam button (turbo steam) in pulses, moving the iron from top to bottom.



- Hold the iron at a distance of a few centimetres from the clothing to avoid burning delicate fabrics.



### Dampening clothing (Spray)

- When dry or steam ironing, press repeatedly on the spray button to moisten clothing and remove stubborn creases.
- Ensure that there is water in the tank before using the spray button.



### While ironing

- Do not lay the iron down on the soleplate; use the heel rest for this purpose.



### Auto-Off Function (according to model)

- If the iron remains unused for more than 8 minutes on the heel rest or more than 30 seconds laid flat or on its side, the electronic system will cut the power, the iron will stop heating **and the auto-off indicator will begin to flash.**
- To restart the iron, move it gently until the indicator stops flashing.

## IRON STORAGE AND MAINTENANCE

### Storing your iron

- Unplug the iron and wait for the soleplate to cool (approx. 1 hour).



- Empty the water tank.



- Set the steam control to .



- Wrap the cord lightly around the bottom of the iron's body. Store the iron on its heel rest.



## Cleaning the anti-calc Collector (3 times a year)



- Unplug the iron, empty the water tank and wait for the soleplate to cool down (approx. 1 hour).



- Once the steam iron has completely cooled down, raise and turn the tab of the collector to unlock it.



- Remove the collector from the iron, it contains the limescale collected in the iron.



- To clean the collector thoroughly rinse in water to remove the limescale inside.



- Reposition the collector in its housing and turn the tab a quarter turn to the right in order to lock the collector and ensure it is watertight.



**Warning !** The iron does not work without the limescale collector.

## Cleaning the anti-calc valve (once per month)



- Unplug your iron and empty the water tank.



- To remove the anti-calc valve, open the water tank cover and pull on the valve near the steam control.



- Soak the valve for 4 hours in a glass of water with lemon juice.



- Rinse the valve under the tap.



- Insert the valve in place, pushing it until you hear a click.



**Beware!**  
Never touch the end of the valve.  
The iron will not function without the anti-calc valve.



## Descaling the steam chamber (3 times a year)



- Allow your iron to heat up with a full water tank while on its heel rest and with the temperature control set to maximum.



- Once the indicator light switches off, unplug the iron and place it over a sink.

- Remove the anti-limescale collector.



- Shake the iron gently in a horizontal position above the sink until some of the water (containing the impurities) leaks from the soleplate. You may push the turbo steam trigger to help flush out the minerals.



- To finish the process, replace the anti-limescale collector, pushing it until you hear a click.



- Plug in your iron for 2 minutes on the heel rest to dry the soleplate.



- Unplug your iron and, once cooled, wipe it with a soft cloth.

- Never use chemical or abrasive products.



During the next use, turn on your iron in a horizontal position without putting it into contact with your laundry in order to eliminate any water containing mineral residues that remain in the soleplate.

### Cleaning the soleplate



- While the soleplate is still cool, clean it with a damp non-metallic pad.



- Never use chemical or abrasive products.

# IS THERE A PROBLEM WITH YOUR IRON?

PROBLEMS	POSSIBLE CAUSES	SOLUTIONS
<b>Water is leaking from the holes in the soleplate.</b>	You are using the steam when the iron is not hot enough.	Wait for the indicator light to turn off.
	You are using the turbo steam button (turbo steam) too often.	Wait a few seconds between each use.
	You have stored the iron horizontally without emptying the water tank or setting the steam control to ☒.	See the chapter on "Storing your iron".
<b>The iron leaks at the start of ironing.</b>	You have removed the anti-limescale collector to fill up your iron.	Do not remove the anti-limescale collector when filling the iron.
	The steam control dial is not set to ☒ when filling the water tank.	Ensure that the steam control dial is set to ☒ when filling the water tank.
<b>A brown discharge coming from the soleplate is staining the clothing.</b>	You are using chemical descaling agents.	Do not introduce a descaling agent into the water tank.
	You are not using the right type of water.	Clean the steam chamber and see the chapter on "What water should I use?"
	Clothing fibres are building up in the holes of the soleplate and burning.	Clean the steam chamber and the soleplate with a damp sponge. Periodically vacuum the holes the holes in the soleplate.
<b>The soleplate is dirty or brown and may stain clothing.</b>	The temperature of the iron is too hot.	Clean the soleplate as indicated above. Consult the table of temperatures to adjust the temperature.
	You are using starch.	Clean the soleplate as indicated above. Spray the starch on the reverse side of the clothing to be ironed.
	Your laundry has not been rinsed sufficiently or you are ironing a new item of clothing before washing it.	Ensure that your laundry is sufficiently rinsed to eliminate potential soap deposits or chemical products on new items of clothing.

## IS THERE A PROBLEM WITH YOUR IRON?

PROBLEMS	POSSIBLE CAUSES	SOLUTIONS
<b>Your iron produces little to no steam.</b>	The water tank is empty.	Fill it up.
	The anti-limescale collector is dirty.	Clean the anti-limescale collector.
	Your iron is clogged up with limescale.	Clean the anti-limescale collector and steam chamber.
	Your iron has been used for too long in the dry ironing function.	Clean the steam chamber.
<b>The soleplate is scratched or damaged.</b>	You have placed your iron on a metallic iron rest or ironed over metal zips or fasteners.	Always place your iron on its heel rest when not in use. Do not iron over metal zips or fasteners.
<b>The iron steams once the water tank has been filled.</b>	The steam control dial is not set to ☒.	Ensure that the steam control dial is set to ☒.
	The water tank is too full.	Do not exceed the max level for filling.
<b>The spray does not spray water.</b>	The water tank is not full enough.	Add water to the water tank.

**If you have any problems or queries please call our Customer Relations team first for expert help and advice: consult our website for contact details: [www.t-falusa.com](http://www.t-falusa.com)**

## Environment



### Environment protection first !

- ➡ Leave it at a local civic waste collection point.
- ⓘ Your appliance contains valuable materials which can be recovered or recycled.